



**GENERAL NOTES**

1. ANY MISCELLANEOUS ITEMS OR MATERIALS NOT SPECIFICALLY NOTED, BUT REQUIRED FOR THE PROPER EXECUTION, INSTALLATION, OR PERFORMANCE OF THE WORK, SHALL BE PROVIDED BY THE CONTRACTOR AT NO ADDITIONAL COST TO OWNER.
2. THE LIMITS OF WORK DESCRIBED IN THE DRAWINGS ARE APPROXIMATE. THE WORK REQUIRED OUTSIDE THESE LIMITS WHICH IS NEEDED TO MEET THE INTENT OF THE DRAWINGS IS THE RESPONSIBILITY OF THE CONTRACTOR. RESTORATION OF THIS ADDITIONAL AREA WILL BE AT THE COST OF THE CONTRACTOR.
3. ALL CONNECTIONS TO EXISTING WORK SHALL BE SMOOTH AND CONTINUOUS, AND MAINTAIN POSITIVE DRAINAGE.
4. ALL CONCRETE JOINTS ARE TO BE SAWCUT UNLESS NOTED OTHERWISE.
5. SCORE JOINTS SHALL BE LOCATED IN CRITICAL POINTS AND SPACED EVENLY BETWEEN THOSE CRITICAL POINTS SHOWN ON THE PLAN.
6. POINTS OF TANGENCY FOR ALL RADII TO BE SMOOTH AND CONTINUOUS, FIELD ADJUST IF NECESSARY.
7. DIMENSIONS ARE PROVIDED FOR CONVENIENCE, CONTRACTOR TO VERIFY WITH STAKING IN THE FIELD.

**LEGEND**

	PERMEABLE PAVERS
	BARK MULCH
	LAWN SEED
	STABILIZED LIMESTONE SCREENINGS
	APPROXIMATE LIMITS OF WORK
	METAL EDGING
	RETAINING WALL
	TABLE
	ADIRONDACK CHAIR
	FIRE FEATURE
	BIKE RACK
	TRASH RECEPTACLE
	TRASH ENCLOSURE
	PERGOLA

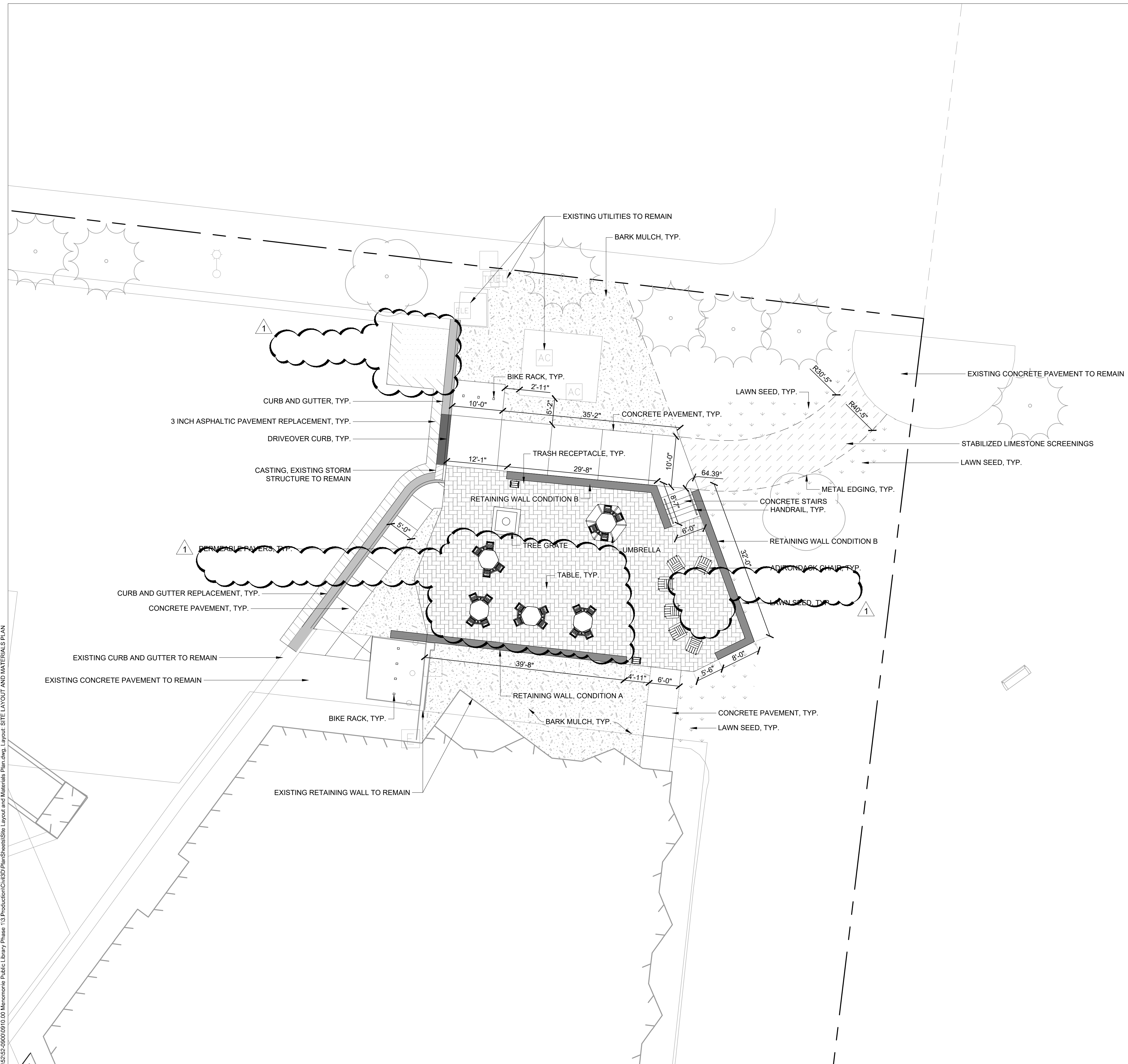

**MENOMONIE PUBLIC LIBRARY PLAZA**

**MENOMONIE PUBLIC LIBRARY**

600 WOLSKE BAY RD., MENOMONIE, WI 54751

Designed By: TW		
Checked By: TR, CS		
REVISIONS		
MARK	DATE	DESCRIPTION
△	11.18.2024	CHANGE ORDER #1

Project Number:	52-0910.00
Set Type:	100% CD SET
Issue Date:	10/9/2024

SITE LAYOUT AND MATERIALS PLAN

C400